

# Specification sheet



A **PACCAR** COMPANY

## FAD XF105 8x4 rigid Airglider



### Engines

XF105.510; 375 kW

### GVM<sup>1)</sup>

32300 kg

### GCM<sup>2)</sup>

58000 kg

Max. front<sup>3)</sup>: 14200 kg

Max. rear: 18100 kg

	Wheelbase - AE		Unladen weight <sup>4)</sup>			Gross Carrying Capacity			Variable dimensions									
	WB	AE <sup>5)</sup>	Front	Rear	Total	Front	Rear	Total	AC	CB <sup>6)</sup>	CH <sup>7)</sup>	BL <sup>8)</sup>	BL <sup>8)</sup>	TL	HA <sup>9)</sup>	HA <sup>10)</sup>	TK <sup>11)</sup>	TW <sup>12)</sup>
Space	6.00	3.25	7035	2285	9320	3765	12715	16480	0.88	0.19	2.47	7.60	7.70	10.62	1.00	0.98	20.98	22.45
Super Space	6.00	3.25	7050	2280	9330	3750	12720	16470	0.88	0.19	2.86	7.60	7.70	10.62	1.00	0.98	20.98	22.45

Other dimensions VA: 1.37 WD: 2.05 WT: 1.37 HV<sup>13)</sup>: 1.02 HV<sup>14)</sup>: 0.98 RB: 0.86 SB: 1.84 TB: 2.45

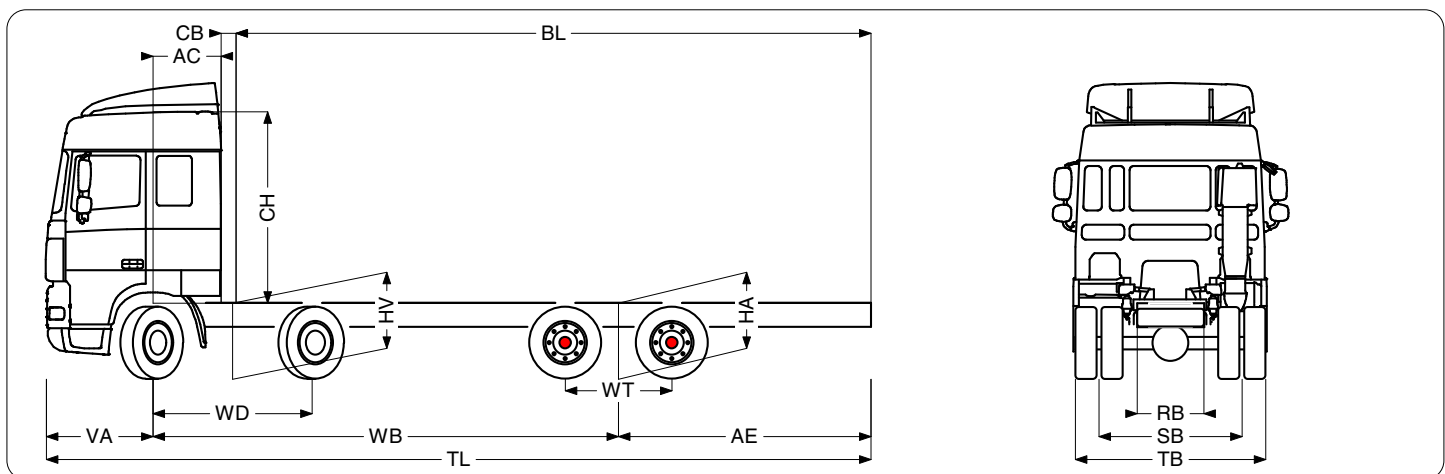

- 1) GVM in conformity with registration documents.
- 2) GCM in conformity with registration documents.
- 3) Axle load with standard tyre size.
- 4) Chassis and Cab Weight calculated with: Standard specification items only with 0 litres of fuel, 15 litres of AdBlue and driver of 0 kg, tolerance  $\pm 3\%$ . Changing of the specification can have major impact on vehicle weight.
- 5) Other AE dimensions may be available for shown WB. Modify rear overhang to the calculated body length.
- 6) CB is based on standard air intake and/or exhaust.
- 7) Cab height is measured from frame member to closed cabin roof hatch.
- 8) Calculate customer specific body length with TOPEC. Body lengths shown based on evenly distributed load at max axle load.
- 9) Unladen height at centre of driven axle(s).
- 10) Laden height at centre of driven axle(s).
- 11) TK = turning circle between kerbs.
- 12) TW = turning circle between walls.
- 13) Unladen height at centre of front axle(s).
- 14) Laden height at centre of front axle(s).

TOPEC III V6.8 201445b (10951)

# FAD XF105

## 8x4 rigid, Space Cab, Airglider

### Cab exterior

Mechanically suspended Space Cab with steel bumper, tinted glass and electric window openers. Main mirrors and wide angle mirrors electrically heated. Cab width 2490 mm; central door lock system. Door lock switch for the co-driver door on the dashboard. Includes 2 remote control units and 2 transponder keys; translucent external sun visor above the windscreen, colour smoke; main mirrors convex; bi-reflector halogen head lights with impact-resistant Lexan lens; combi lights (fog lamps and spot lamps) in the bumper; single air horn set, consisting of two horns on the cab roof, with pulling chord in the cab.

Optional:

- Super Space Cab, mechanical suspension.

### Aerodynamics

Adjustable aerodynamically shaped roof spoiler.

### Cab interior

Right-hand drive; air bag in the steering wheel. Seat belt tensioners for the driver and co-driver seats; steering wheel black, soft grip black finish; aluminium look finish for the active zones of the dashboard; high backed Luxury Air, air suspended, heated driver's seat; preparation for air blow gun; storage below the lower bunk: left-hand side - airtight box 150 litres with external hatch and open box 60 litres; right-hand side - open box 150 litres with external hatch and open box 85 litres; centre part - open box 25 litres with bottle holder at the front and drawer 65 litres with moveable partition next to the refrigerator. Spacers are used below the mattress for extra ventilation, in order to remove damp from the refrigerator; refrigerator drawer 42 litres with luxury aluminium look grip underneath the lower bunk; manually controlled airco with air recirculation; pollen filter. Effectiveness 85% for particles up to 0.5 micron and 98% for particles up to 10 micron.

Optional:

- Dashboard: Wood structure
- Auxiliary cab heater (air)
- Auxiliary cab heater (air) with timer
- Upper bunk
- Automatic temperature control

### Communication and driving management

Universal FMS (Fleet Management System) connector with wiring, to read information as defined in the truck manufacturers' FMS standard; luxury radio/USB player with remote control. Speaker system with 6 speakers; handsfree telephone kit. Includes steering wheel button functions for telephone call start/stop, redial last numbers and phone book. Telephone information display on the LCD screen in the instrument panel; standard antennas: AM/FM, GSM and GPS. Second GSM antenna for telephone. Extra antenna: CB; Cruise control.

### Safety and security

Basic engine immobiliser with fuel injection inhibit and interruption of the starter motor circuit.

Optional:

- Lane Departure Warning System
- Reverse warning

### Suspension and axles

Front axle type 152N, 100 mm vertical offset. Parabolic leaf suspension with shock absorbers and stabiliser. Max. load 2x 7.1 tonnes; type MT23-165 double driven rear tandem axles with single reduction. Lockable inter-axle and cross-axle differentials. The two tandem axles are each suspended with 4 air bellows and include shock absorbers and a stabiliser. Max. load 2 x 9.0 tonnes.

### Wheels and tyres

Front axles: tyre size 275/70R22.5, wheel size 22.5 x 8.25; rear axles: tyre size 275/70R22.5, wheel size 22.5 x 8.25; supplier Goodyear; disc wheels aluminium, Alcoa Dura-Bright, mounting holes 32 mm.

### Driveline

MX engine: 12.9 litres, 6 cylinder diesel engine. Engine performance according to ECE R24-03: output 375 kW (510 hp) at 1500-1900 rpm. Torque 2500 Nm at 1000-1410 rpm. Max. ambient temperature 38 degrees Celsius, Heavy Duty; exhaust emission Euro 5; AS Tronic gearbox, 16 speeds. Includes Hill Start Aid (HSA) function; rear axle ratio 3.42.

Optional:

- MX340, 340 kW/462 hp, 38C HD.
- Cab badge: 460
- Engine idle shutdown, 5 minutes
- Manual Roadranger gearbox, 18 speeds

### Brake system

ZF Intarder. The ZF Intarder is a hydrodynamic secondary retarder system, integrated in the gearbox. Maximum braking power 500 kW; dual circuit full air brake system. Disc brakes front, drum brakes rear. Twin cylinder air compressor with heated air dryer, 670 l/min at 10 bar. Rear axle load sensing valve; Anti-lock Brake System (ABS).

Optional:

- MX Engine Brake

### Chassis

Side member height 310 mm, thickness 6.0 mm. Full length inner reinforcement; 1 circuit steering system; silencer at the right-hand side of the chassis, batteries at the left-hand side; aluminium fuel tank 430 litres, height 620 mm; front underrun protection (FUP), according to EU directive 2000/40/EEC; AdBlue tank 140 litres.

Optional:

- AdBlue tank 40 litres.

### Drawbar and trailer equipment

Pneumatic trailer connection with C-type couplings; no independent trailer valve; electric trailer connection 24V with two 7-pin sockets.

### Bodies and preparations for bodying

Connector for analogue engine speed control on the cab front bulkhead. Control functions for engine speed adjustment, programmed engine speed selection, application speed limiter and remote engine start/stop; bodybuilder module light; application connector for body functions on the cab front bulkhead. Electric signals for -Cab tilt locked- and -Engine running-. Power supply 24 V before and after contact. Spare wiring to the dashboard.

### Power take-off (PTO)

Analogue gearbox PTO control, no gearbox PTO. Includes a PTO switch on the dashboard and a PTO control valve on the chassis. PTO connector on the cab front bulkhead with input signals for PTO engagement or disengagement and signals for PTO status indication and PTO warning.

### Electrical power supply

Alternator 80 A, batteries 2x 230 Ah.

### GVM and GCM

Technical GVM max. 32300 kg; technical GCM max. 58000 kg class 2.

### Application conditions

Coolant filter; unheated moisture separator with pre-filter; air intake high; no oil cooler gearbox.

Optional:

- Air intake front

### Service and maintenance

Warranty takes care of 1 year complete vehicle, 2nd and 3rd year driveline.

### Vehicle delivery

Standard toolkit.

Depending on the vehicle configuration a specific option may not be possible. The availability and specification of this vehicle may differ per country. For further information please contact the DAF organisation.  
Subject to modification without prior notice.