

Specification sheet

CF 370

FT 4X2 Tractor

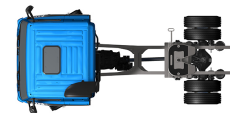

ENGINES

CF 370 MX-11 (270 kW / 367 hp)

CF 410 MX-11 (300 kW / 408 hp)

CF 450 MX-11 (330 kW / 449 hp)

GVM¹⁾

15400 kg

Max. front 7200 kg

Max. rear 8200 kg

GCM²⁾

44000 kg

82708709EAAA - 202017P - 17-01-2020

New Zealand, Southpac Trucks Ltd, www.spt.co.nz

CAB EXTERIOR

Sleeper Cab with galvanised steel bumper, tinted glass and electric window openers. Main mirrors and wide angle mirrors electrically heated. Cab width 2300 mm.; LED daytime running lights; Manually adjustable main mirrors; No front view mirror.

Optional

01899 Day Cab	09983 Fog lights
01137 Space Cab	09984 Fog lights and cornering lights
01226 Cab suspension air	06593 Skylights
01174 External sun visor green translucent	06628 One hazard beacon light at co-driver side
00847 Air horns, single set	06627 One hazard beacon light at driver side
09006 Air horns, double set	06629 Two hazard beacon lights
08020 LED head lights	

AERODYNAMICS

Optional

07840 Adj. roof air deflector, wide, for Sleeper Cab	04906 Side collars
07841 Adj. roof air deflector, wide, for Space Cab	04146 Side skirts
06776 Adjustable roof air deflector	

COLOURS

Cab colour H3279 Brilliant White; Head lamp panel and bumper: Brilliant White; Chassis colour grey..

Optional

06485 Head lamp panel and bumper: cab colour	09933 Head lamp panel and bumper: Stone Grey
---	---

CAB INTERIOR

Cab interior trim colour Dark Sand; Cab interior decoration Black Rock; Driver seat: Comfort Air; Co-driver seat: basic; Lower bunk, normal level; Automatic Temperature Control and airco; No auxiliary cab heater; Roof hatch aluminium, manual control; Pollen filter.

Optional

09271 Steering wheel, leather, colour black	07748 Co-driver seat: Xtra Leather Air
07240 Steering wheel, leather, Exclusive	00967 Seat belts red
07152 Cab interior trim colour Exclusive	02117 Third seat
07592 Cab interior decoration Argenta	06539 Refrigerator
07591 Cab interior decoration Rustica	31364 Without feature: Lower bunk mattress
07733 Driver seat: Luxury Air	06784 Lower bunk mattress Xtra Comfort
07736 Driver seat: Super Air	31365 Without feature: Upper bunk
07737 Driver seat: Xtra Leather Air	01066 Upper bunk
07741 Co-driver seat: Comfort Air	06676 PL light in cab ceiling
07743 Co-driver seat: Luxury Air	06970 Automatic Cab Climate Control
07746 Co-driver seat: Super Air	

COMMUNICATION AND DRIVING MANAGEMENT

Tachograph mechanical; Speed limiter setting 100 km/h; Antennas: AM/FM, 2x GSM, GPS; Cruise control.

Optional

08450 Luxury speaker system with 6 speakers	07261 TruckPhone
07117 Radio/USB player, 2 speakers	08891 Adaptive Cruise Control with FCW and AEBS

SAFETY AND SECURITY

No Lane Departure Warning System; Vehicle Stability Control (VSC); Basic engine immobiliser system.

Optional

08631 Air bag (driver) and 2 seat belt tensioners	09827 Side camera system
09828 Front camera system	01725 Reverse warning

SUSPENSION AND AXLES

Front axle load 7.50 t; Rear: 13.00 t, air suspension, SR1344.

Optional

08191 Axle load monitoring

WHEELS AND TYRES

Front axle 1: 315/70R22.5; Rear axle 1: 315/70R22.5; Disc wheels steel, silvergrey; No wheel protection rings.

Optional

16152 Tyre makes and types

DRIVELINE

Engine MX-11, multi torque 6 cylinder diesel engine, 10.8 litres. Output 270 kW (367 hp) at 1600 rpm. Maximum torque 1900 Nm at 900-1125 rpm.; Exhaust emission Euro 6; Engine idle shutdown, 5 minutes; Automated gearbox, TraXon, 12 speeds; Gearbox ratio 16.69-1.00; Rear axle ratio 2.47; ASR.

BRAKE SYSTEM

Exhaust brake; Park brake control; Ventilated disc brakes front and rear. Dual circuit air system with electronic control (EBS). Twin cylinder air compressor with heated dryer and economy mode..

Optional

09921 MX Engine Brake	02715 ZF Intarder
------------------------------	--------------------------

CHASSIS

Wheelbase 3.60 m / rear overhang 0.99 m; Side member height 260 mm; Component-free right hand side, 1400 mm; Exhaust pipe horizontal, low; Aluminium fuel tank 340 l, height 620 mm; Rear mudguards; Worklamp white; Spray suppression; Front underrun protection (FUP); Catwalk with step; AdBlue tank 45 litres on left-hand mudguard.

Optional

01179 Standard component location	03624 One wheel chock
06611 Exhaust pipe vertical, high	06306 Two wheel chocks
08641 Air tanks aluminium	03323 Rear light with LEDs
07053 Worklamp LED	

DRAWBAR AND TRAILER EQUIPMENT

; No fifth wheel KA dimension; Pneumatic trailer connection C-type; Electric connection 24 V / 2x7 pins.

Optional

03178 Towing hook D= 4.3	06731 Chassis protection beam
04359 Lead-up ramps	

POWER TAKE-OFF (PTO)

Optional

16148 PTO types and positions

ELECTRICAL POWER SUPPLY

Alternator 80 A, batteries 2x 175 Ah..

Optional

06460 Alternator 120 A

06440 Batteries 2x230Ah

08775 Alternator 150 A

GVM AND GCM

Chassis weight related technical GVM max 20500 kg; Driveline related max GCM 44000 kg class 2.

APPLICATION CONDITIONS

Air intake on the cab roof.

Optional

09961 Cyclonic air intake behind the cab

SERVICE AND MAINTENANCE

Standard Warranty takes care of 1 year complete vehicle, 2nd year driveline.; ITS service.



Go to [DAF.com](https://www.daf.com) to configure your own perfect DAF.

CF 370

FT 4X2 Tractor

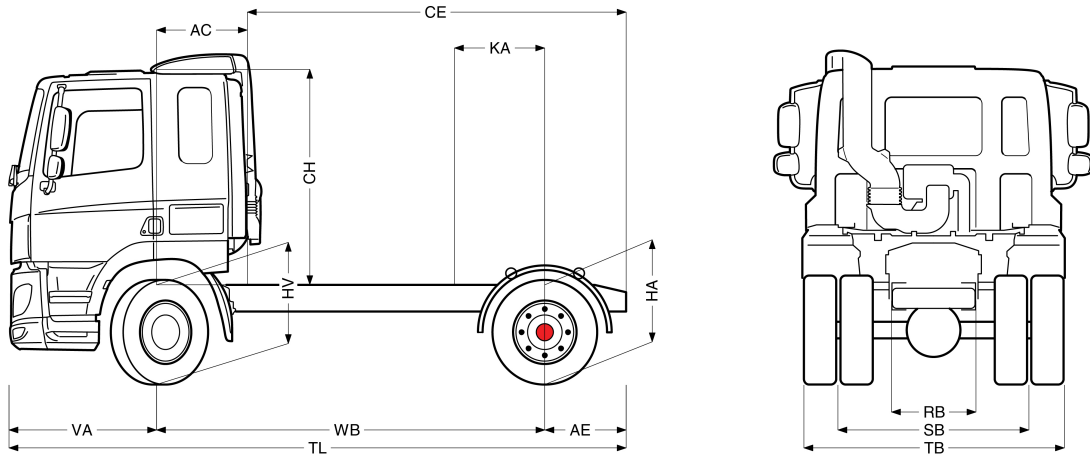

	Wheelbase - AE		Unladen weight ¹⁾			Gross Carrying Capacity			Variable dimensions								
	WB	AE ⁵⁾	Front	Rear	Total	Front	Rear	Total	AC	CE	CH ⁶⁾	KA ⁷⁾	TL	HA ⁸⁾	HA ⁹⁾	TK ¹⁰⁾	TW ¹¹⁾
DAY CAB	3.60	0.99	4763	1794	6557	2437	6406	8843	0.39	4.20	1.99	0.00	5.96	1.07	1.04	12.91	14.26
SLEEPER CAB	3.60	0.99	4822	1761	6583	2378	6439	8817	0.82	3.77	1.99	0.00	5.96	1.07	1.04	12.91	14.26
SPACE CAB	3.60	0.99	4938	1757	6695	2262	6443	8705	0.82	3.77	2.67	0.00	5.96	1.07	1.04	12.91	14.26

OTHER DIMENSIONS	VA: 1.37	HV ¹²⁾ : 0.97	HV ¹³⁾ : 0.96	RB: 0.79	SB: 1.82	TB ¹⁴⁾ : 2.48
------------------	----------	--------------------------	--------------------------	----------	----------	--------------------------

1) GVM in conformity with registration documents.
 2) GCM in conformity with registration documents.
 3) Axle load with standard tyre size.
 4) Chassis and cab weight calculated with: Standard specification items only with 340 litres of fuel, 45 litres of AdBlue® and driver of 100 kg, tolerance ± 3%. Changing of the specification can have major impact on vehicle weight.
 5) Other AE dimensions may be available for shown WB.
 6) Cab height is measured from frame member to closed cab roof hatch. With air intake on cab roof add: 0.14 m (for MX-11); add 0.21 m for MX-13.
 7) Calculate customer specific KA with TOPEC.

8) Unladen height at centre of driven axle(s).
 9) Laden height at centre of driven axle(s).
 10) TK = turning circle between kerbs.
 11) TW = turning circle between walls.
 12) Unladen height at centre of front axle(s).
 13) Laden height at centre of front axle(s).
 14) TB is overall width at rear. (At lower cab step 255).

Depending on the vehicle configuration a specific option may not be possible. The availability and specification of this vehicle may differ per country. For further information please contact the DAF organisation. Pictures and technical illustrations are not binding in detail and can differ from the standard specification. Subject to modification without prior notice.